





<http://www.ruijie.com.cn/>

<http://webchat.ruijie.com.cn>

<http://www.ruijie.com.cn/service.aspx>

7 24

4008-111-000

<http://bbs.ruijie.com.cn/portal.php>

# 1

RG-AP520(BT)

AP520(BT)

AP( Fit AP )

/

AP( Fat AP )

## 1.1 RG-AP520(BT)

	2.4G 2 2MIMO
	5G 2 2MIMO
	2.4G 802.11b/g/n
	5G 802.11a/n/ac
	802.11b/g/n 2.4G ~ 2.4835GHz
	802.11a/n/ac 5G 5.150 5.350GHz 5.47 5.725 5.725 5.850GHz (
	3dBi
	2
	2.4G 300Mbps 5G 867Mbps
	1.167Gbp

OFDM BPSK@6/9Mbps QPSK@12/18Mbps 16-QAM@24/36Mbps 64-QAM@48/72Mbps 256-QAM@96/144Mbps 512-QAM@192/288Mbps

	-40°C 70°C
	5 95
	5 95
	IP41
	GB4943 IEC 60950-1
EMC	GB9254 EN301 489 EN50155 EN50121
	IEC61373
	EN300 328 EN301 893
MTBF	>400000H

RG-AP520(BT) 2 1 PoE Console

1-1



ap



		AP /
	3Hz	AP
		AP
	3Hz	AP Link down
	3Hz	AP CAPWAP
	3Hz	AP
		AP CAPWAP
	16 /min	AP CAPWAP
		AP
	3Hz 2 2	AP AP

ap

		AP /
	3Hz	

**2**

).(

---

RG-AP520(BT)

---

**2.2**

## 2.5

RG-AP520(BT)

### 2.5.1

RG-AP520(BT)

RG-AP520(BT)

### 2.5.2

RG-AP520(BT)

### 2.5.3

RG-AP520(BT)

RG-AP520(BT)

-10 C-55 C	5%-95%

### 2.5.4

( m)	0.5	1	3	5

H <sub>2</sub> S	0.006	0.03
NO <sub>2</sub>	0.04	0.15
NH <sub>3</sub>	0.05	0.15
Cl <sub>2</sub>	0.01	0.3

### 2.5.5

DC11.4-12.6V      0.3A      15W

10. DC Cord Drawing (线材正在承样, 图纸仅供参考)

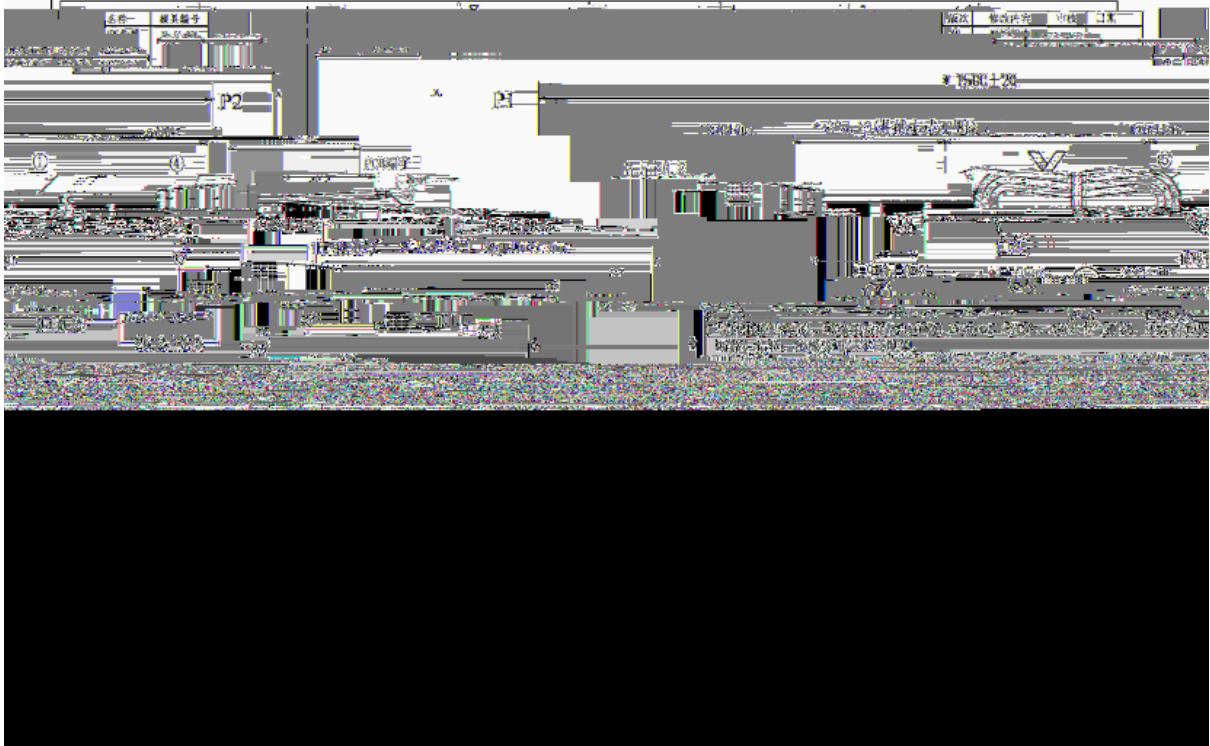

PoE      802.3af/802.3at      PoE

RG-AP520(BT)

12.95W PoE

### 2.5.6 EMI

### 2.6

--	--



### 3

RG-AP520(BT) AP

---

---

#### 3.1

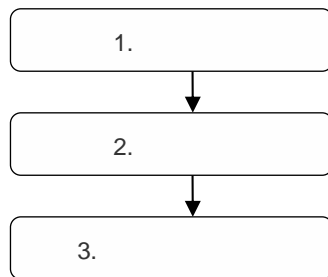

#### 3.2

RG-AP520(BT)

#### 3.3

AP

### 3.4

---

---

1)                    4                    6mm                    61mm

3-1

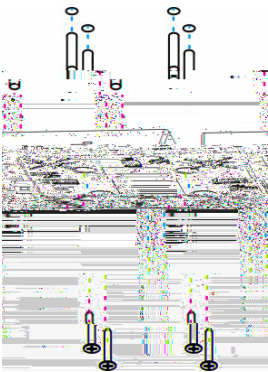

3-2



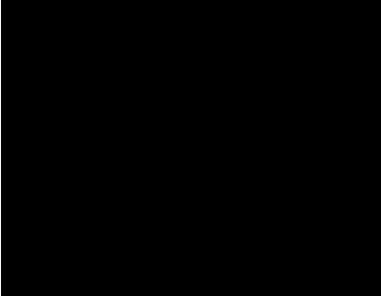

3-6

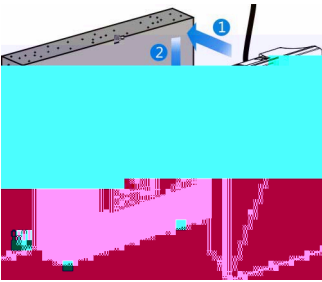

" Ruijie" logo

---

## 3.5

1)

3-7

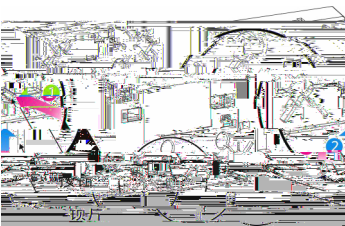

3-8



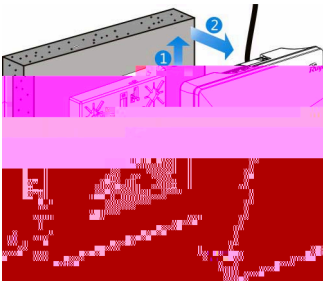

3-12

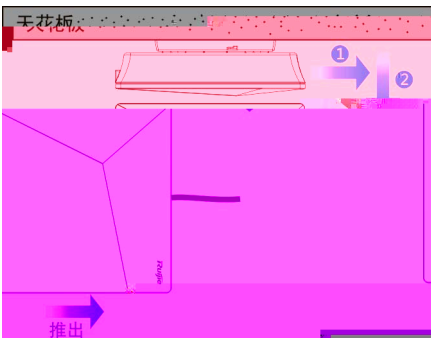

### 3.7

AP	LAN/PoE	AP	A
console	9600	8	1
RG-AP520(BT)			RG-AP520(BT)

### 3.8

1)

LAN/PoE

**3.9**

AP

## 4

### 4.1

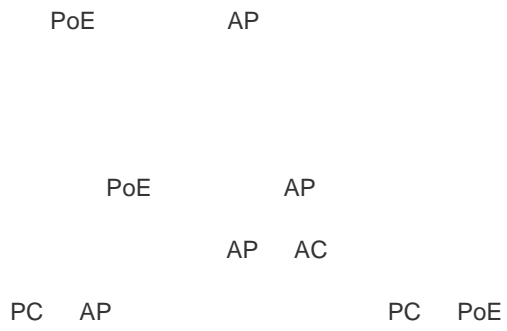

### 4.2

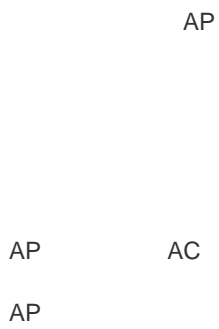

## 5

### 5.1

RG-AP520(BT)

```
AP
AP                               Link down
AP                               CAPWAP
AP
AP           CAPWAP
16  /min  AP           CAPWAP
AP
2      2      AP           AP
AP  /
```

### CLI

RG-AP520(BT) AC

---

```
RG-AP520(BT)           Telnet           RG-AP520(BT)
RG-AP520(BT)
```

---

### 5.2

```
AP           AP           AP
AP           AP           AC
```

### 5.3

## 6

### 6.1

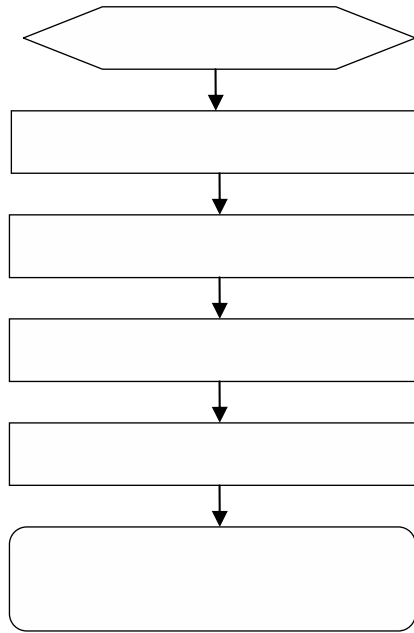

AP

AP

,

,

**A** — —

**1000BASE-T/100BASE-TX/10BASE-T**

1000BASE-T/100BASE-TX/10BASE-T

MDI/MDIX Crossover

1000BASE-T IEEE 802.3ab  
100

100-ohm 5 5

UTP STP

1000BASE-T 4

4 1000BASE-T

A-1 1000BASE-T

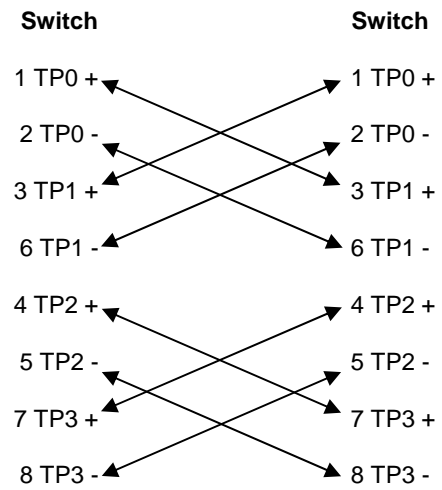
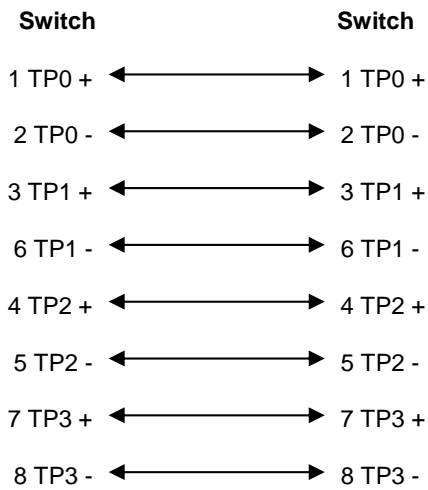
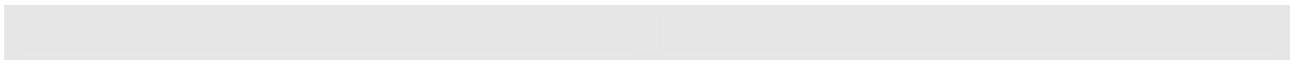

100BASE-TX/10BASE-T  
100Mbps 100-ohm 5

100

10Mbps 100-ohm 3 4 5  
100BASE-TX/10BASE-T

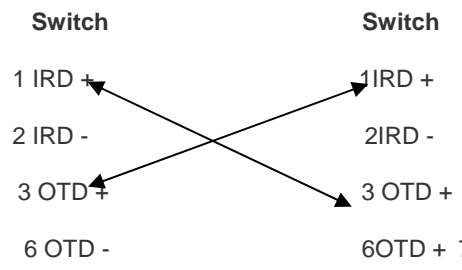
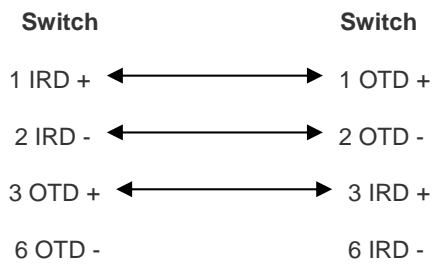

7 -35346 | -89.8





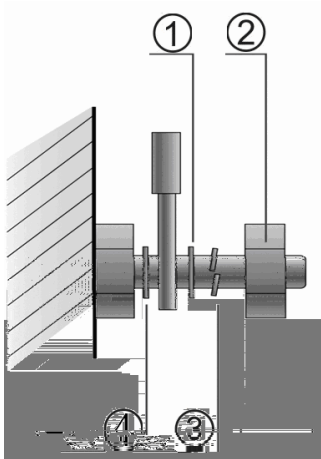

( mm )	( mm )
10	80~150
10~30	150~200
30	200~300